

2011 COUNTY FIRE DISTRICT MAP

- 1041 - COGSWELL F/P DISTRICT
- 1811 - FORMAN-HAVANNA F/P DIST
- 2211 - GWINNER F/P DISTRICT
- 3041 - LIDGERWOOD F/P DISTRICT
- 3501 - MILNOR F/P DISTRICT
- 3871 - OAKES F/P DISTRICT
- 4351 - RUTLAND-CAYUGA F/P DIST
- 5351 - WYNDMERE F/P DISTRICT

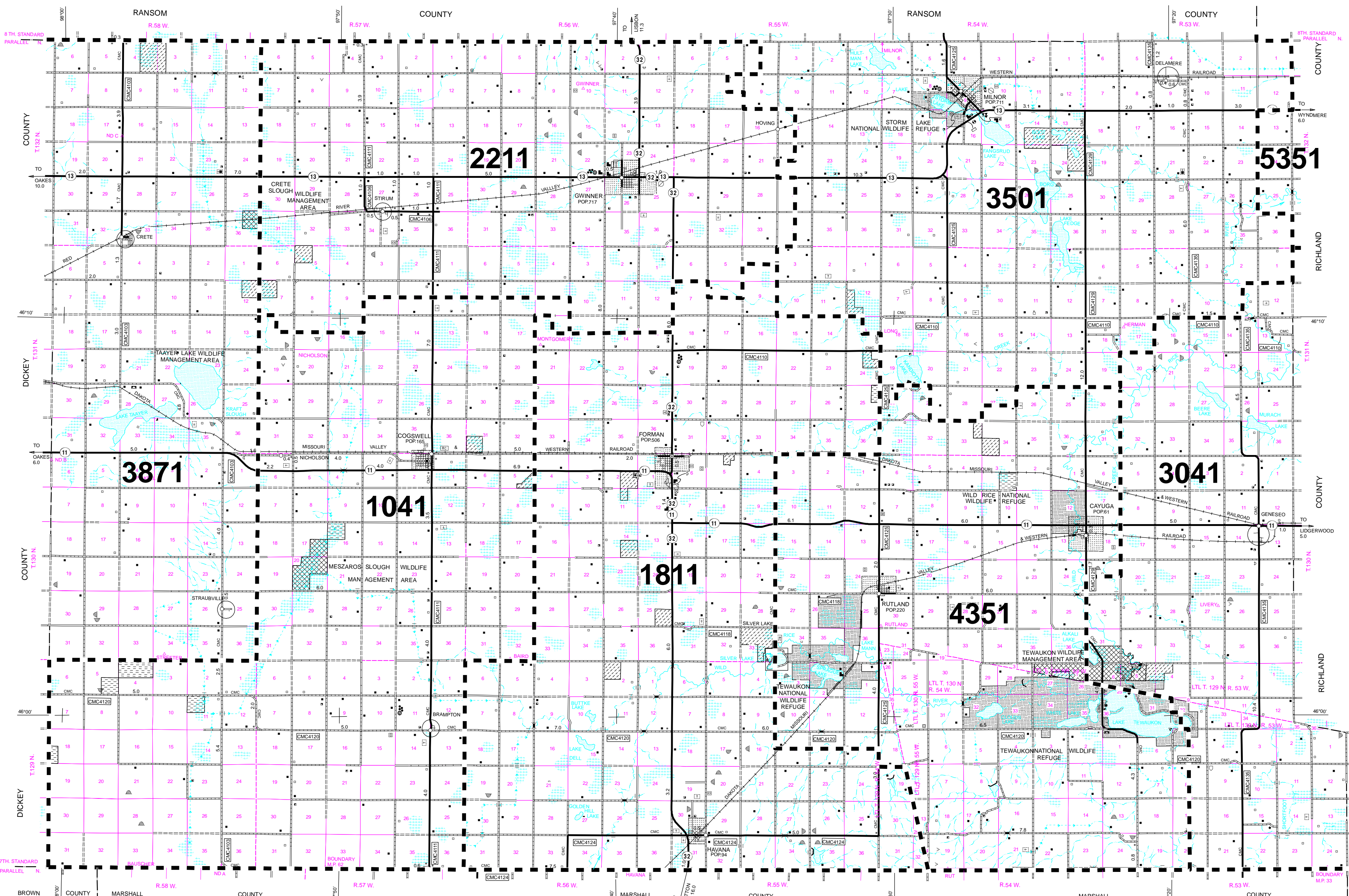

- FORD - ROAD ESTABLISHED
- CONSERVATION AND RECREATION
 - PICNIC GROUND
 - PLAYGROUND, BALL FIELD, ETC.
 - BATHING BEACH OR SWIMMING POOL
 - CAMP SITE, NO PERMANENCE (TENTS OR TRAILER PARKING)
 - TOURIST COURT, OR MOTEL
 - RIFLE CLUB
- AIRPORTS
 - LANDING AREA OR STRIP
- IRRIGATION DITCH
- CANAL
- NAVIGATION
 - DOCK, PIER, OR LANDING
- EDUCATIONAL AND CORRECTIONAL INSTITUTIONS
 - TOWNHALL, GRANGE, OR COMMUNITY HALL
- CITY AND VILLAGE CENTERS
 - COUNTY SEAT
 - OTHER CITIES AND VILLAGES
 - INCORPORATED CITY OR VILLAGE (GENERALIZED)
- LIVELLING OTHER THAN FARM
 - SEASONAL OR SUMMER COLONY
 - DWELLING
 - CHURCH
 - CEMETERY
 - WELL
 - TOLL HOUSE, STATE PORT OF ENTRY, OR WEIGHT STATION
- MISCELLANEOUS
 - TRIANGULATION STATION
 - DOT TO INDICATE LOCATION OF ANY CULTURAL FEATURE SHOWN OUT OF POSITION
 - ALL VACANT CULTURE INDICATED BY OPEN SYMBOL
 - LATITUDE AND LONGITUDE

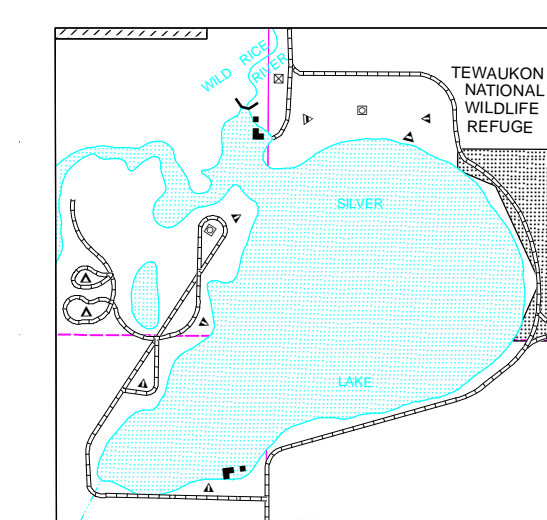

SILVER LAKE
SEC'S. 33 & 34, T. 130 N., R. 55 W.
SEC'S. 3 & 4, T. 129 N., R. 55 W.



STATE OF NORTH DAKOTA
DIAGRAM OF COUNTIES

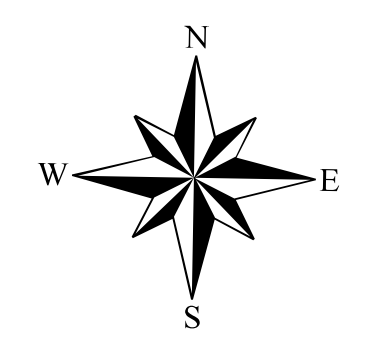

GENERAL HIGHWAY MAP SARGENT COUNTY NORTH DAKOTA

PREPARED BY THE
NORTH DAKOTA DEPARTMENT OF TRANSPORTATION
PLANNING / ASSET MANAGEMENT DIVISION
IN COOPERATION WITH THE
U.S. DEPARTMENT OF TRANSPORTATION
FEDERAL HIGHWAY ADMINISTRATION

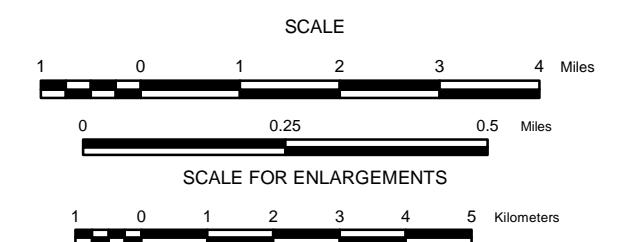

2008

BASED ON AERIAL PHOTOGRAPHY OF 1954
GROUND INVENTORY OF 2008
AERIAL INVENTORY OF 2008
UNIVERSAL TRANSVERSE MERCATOR ZONE 14
NORTH AMERICAN DATUM 83

NAME AND LOCATION OF ORGANIZED CIVIL TOWNSHIPS THOSE UNORGANIZED ARE SO NOTED

- | | |
|------------------------------------|-----------------------------------|
| T. 132 N.-R. 58 W. DENVER | T. 130 N.-R. 54 W. RANSOM |
| T. 132 N.-R. 57 W. VIVIAN | L.T.L.T. 129 N.-R. 54 W. RANSOM |
| T. 132 N.-R. 56 W. WHITESTONE HILL | T. 130 N.-R. 53 W. KINGSTON |
| T. 132 N.-R. 55 W. WILLEY | L.T.L.T. 129 N.-R. 53 W. KINGSTON |
| T. 132 N.-R. 54 W. MILNOR | T. 129 N.-R. 58 W. SOUTHWEST |
| T. 132 N.-R. 53 W. HALL | T. 129 N.-R. 57 W. BRAMPTON |
| T. 131 N.-R. 58 W. VERNER | T. 129 N.-R. 56 W. TAYLOR |
| T. 131 N.-R. 57 W. HARLEM | T. 129 N.-R. 55 W. WEBER |
| T. 131 N.-R. 56 W. BOWEN | L.T.L.T. 129 N.-R. 54 W. WEBER |
| T. 131 N.-R. 55 W. DUNBAR | L.T.L.T. 130 N.-R. 55 W. TEWAUKON |
| T. 131 N.-R. 54 W. SHUMAN | L.T.L.T. 130 N.-R. 54 W. TEWAUKON |
| T. 131 N.-R. 53 W. HERMAN | L.T.L.T. 129 N.-R. 55 W. TEWAUKON |
| T. 130 N.-R. 58 W. JACKSON | L.T.L.T. 129 N.-R. 54 W. TEWAUKON |
| T. 130 N.-R. 57 W. SARGENT | L.T.L.T. 130 N.-R. 53 W. MARBOE |
| T. 130 N.-R. 56 W. FORMAN | |
| T. 130 N.-R. 55 W. RUTLAND | |

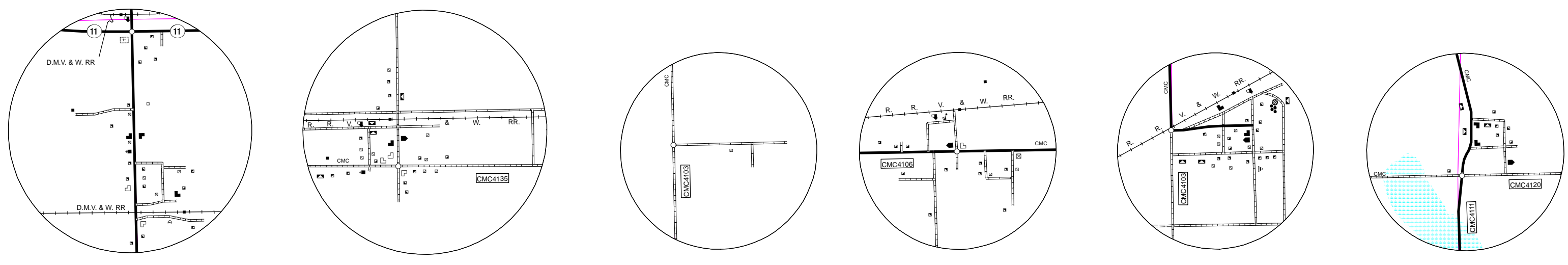

GENESEO SEC'S. 11, 12, 13, & 14, T. 130 N., R. 53 W.
DELAMERE SEC'S. 4 & 9, T. 132 N., R. 53 W.
STRAUBVILLE SEC'S. 25 & 26, T. 130 N., R. 58 W.
STIRUM SEC'S. 27 & 34, T. 132 N., R. 57 W.
CRETE SEC'S. 32 & 33, T. 132 N., R. 58 W.
SEC'S. 4 & 5, T. 131 N., R. 58 W.
BRAMPTON SEC'S. 11, 12, 13 & 14, T. 129 N., R. 57 W.

COPIES OF THIS MAP ARE AVAILABLE FOR PUBLIC USE AT A NOMINAL COST FROM:
MAP SALES, N. D. DEPT. OF TRANSPORTATION, 608 E. BLVD. AVE., BISMARCK, N. D. 58505-0700