

2003 COUNTY FIRE DISTRICT MAP

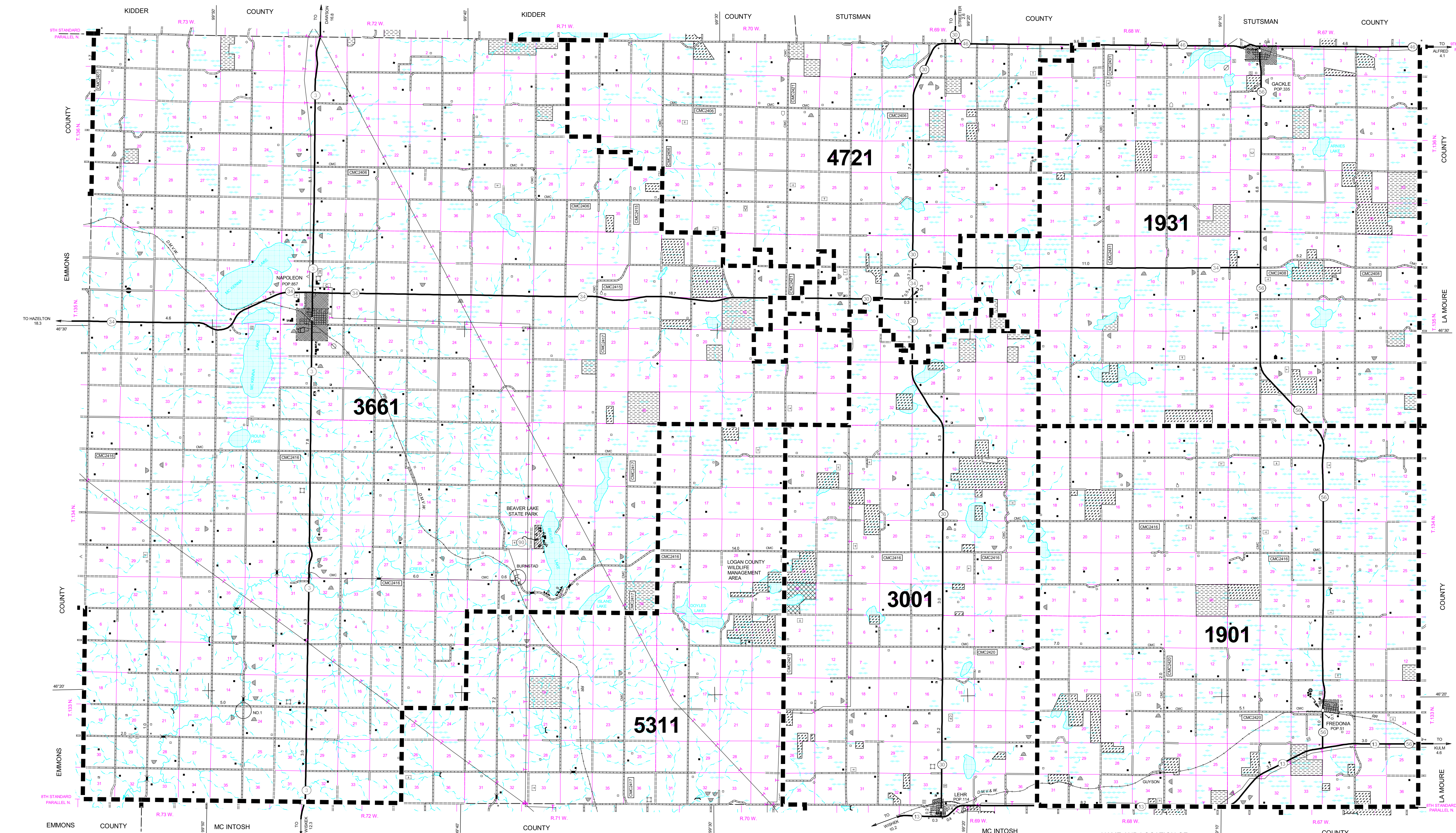

GENERAL LEGEND	
ROADS AND ROADWAY FEATURES	CONSERVATION AND RECREATION
SEMI USED TRAILS	PICNIC GROUND
PRIMITIVE ROAD	PLAYGROUND, BALL FIELD, ETC.
UNIMPROVED ROAD	BATHING BEACH OR SWIMMING POOL
GRADED AND DRAINED ROAD	TOURIST COURT, OR MOTEL
GRAVEL GRADED AND DRAINED ROAD	SMALL PARK (SP-STATE, CP-COUNTY, MP-MUNICIPAL, WP-WAYSIDE PARK)
BITUMINOUS ROAD - LOW TYPE	GOLF GROUND OR COUNTRY CLUB
PAVED ROAD - INCLUDING HIGH TYPE BITUMINOUS	AMUSEMENT PARK OR HALL
STREETS IN UNINCORPORATED TOWNS	FAR GROUND, RACE COURSE, SPEEDWAY
COUNTY MAJOR COLLECTOR ROUTE NUMBER	RIFLE CLUB
POINTS BETWEEN WHICH DISTANCES ARE MEASURED	
U.S. NUMBERED HIGHWAY	AIRPORTS
STATE HIGHWAY SYSTEM	LANDING AREA OR STRIP
RAILROADS	PUBLIC SERVICE FACILITIES
RAILROAD (ANY NUMBER OF TRACKS USED BY A SINGLE OPERATING CO.)	POST OFFICE
RAILROAD STATION	HIGHWAY GARAGE
RAILROAD GRADE CROSSING	FIRE ENGINE HOUSE
RAILROAD ABOVE	GARBAGE OR RUBBISH DUMP
RAILROAD BELOW	SEWAGE DISPOSAL PLANT
RAILROAD BRIDGE	AUTOMOBILE GRAVEYARD
	WATER SUPPLY STAND PIPE OR TANK
	PIPE LINE, GAS
	PIPE LINE, OIL
	TRANSMISSION LINE
	POWER SUBSTATION
STRUCTURES	
HIGHWAY BRIDGE, GENERAL	
HIGHWAY GRADE SEPARATION	
DAM WITH ROAD	
MINOR DRAINAGE STRUCTURE	
CONCRETE FORD OR DIP	
FORD - ROAD ESTABLISHED	
DRAINAGE	EDUCATIONAL AND CORRECTIONAL INSTITUTIONS
PERMANENT STREAM (NARROW)	SCHOOLHOUSE
NARROW STREAM	TOWNHALL, GRANGE, OR COMMUNITY HALL
WIDE STREAM	
WIDE STREAM WITH DAM	
LAKE, RESERVOIR, OR POND WITH DAM	
LAKE, RESERVOIR, OR POND	
MARSH OR SWAMP LAND	
BOUNDARIES	INDUSTRIAL
COUNTY LINE	STORE OR SMALL BUSINESS ESTABLISHMENT
TOWNSHIP LINE	BUSINESS AND POST OFFICE
CORPORATE LINE	FACTORY OR INDUSTRIAL PLANT
SECTION LINE	OIL TANK
BOUNDARY TO MARK ENLARGEMENT INSET	GAS TANK
WILDLIFE MANAGEMENT AREA	GROUP OF STORAGE TANKS (OIL OR GAS)
WATERFOWL PRODUCTION AREA	FILLING STATION
STATE PARKS	PUMPING STATION (OIL OR GAS)
STATE SCHOOL LAND	GAUGING OR PUMPING STATION
	WAREHOUSE - GENERAL
	GRAIN ELEVATOR
	BEEHIVE
	STOCK YARD - LOADING PEN OR CORRAL
	GRAVEL PIT
	OIL OR GAS WELL
FARM UNITS, DWELLINGS, ETC.	CITY AND VILLAGE CENTERS
FARM UNIT (FARM UNITS SHOWN IN MUNICIPAL LIMITS INDICATE FARM BUILDINGS FOR FARM USE)	COUNTY SEAT
DWELLING OTHER THAN FARM	OTHER CITIES AND VILLAGES
ROWS OR GROUPS OF DWELLINGS CLOSELY SPACED FIGURE DENOTES NUMBER OF DWELLINGS	INCORPORATED CITY OR VILLAGE (GENERALIZED)
SEASONAL OR SUMMER COLONY DWELLING	
SEASONAL DWELLINGS CLOSELY SPACED	
HOTEL OR INN	
CEMETERY	
CHURCH	
CHURCH WITH CEMETERY ADJACENT	
	MISCELLANEOUS
	TRIANGULATION STATION
	DOT TO INDICATE LOCATION OF ANY CULTURAL FEATURE SHOWN OUT OF POSITION
	BY OPEN SYMBOL
	ALL VACANT CULTURE INDICATED BY OPEN SYMBOL
	PLANE COORDINATE LINES
	LATITUDE AND LONGITUDE

- 1901 - FREDONIA F/P DIST
- 1931 - GACKLE RURAL FIRE DEPT
- 3001 - LEHR RURAL FIRE DEPT
- 3661 - NAPOLEAN F/P DISTRICT
- 4721 - STREETER F/P DISTRICT
- 5311 - WISHEK F/P DISTRICT

CITY FIRE DEPARTMENTS
3000 - LEHR FIRE DEPT

NAME AND LOCATION OF ORGANIZED CIVIL TOWNSHIPS THOSE UNORGANIZED ARE SO NOTED

- T. 136 N.-R. 73 W. SEALY
- T. 136 N.-R. 72 W. GLENDALE
- T. 136 N.-R. 71 W. UNORGANIZED
- T. 136 N.-R. 70 W. UNORGANIZED
- T. 136 N.-R. 69 W. UNORGANIZED
- T. 136 N.-R. 68 W. UNORGANIZED
- T. 136 N.-R. 67 W. FINN
- T. 135 N.-R. 73 W. KROEBER
- T. 135 N.-R. 72 W. BRYANT
- T. 135 N.-R. 71 W. DIXON
- T. 135 N.-R. 70 W. UNORGANIZED
- T. 135 N.-R. 69 W. UNORGANIZED
- T. 135 N.-R. 68 W. UNORGANIZED
- T. 135 N.-R. 67 W. GUTSCHMIEDT
- T. 134 N.-R. 73 W. UNORGANIZED
- T. 134 N.-R. 72 W. STARKEY
- T. 134 N.-R. 71 W. RED LAKE
- T. 134 N.-R. 70 W. UNORGANIZED
- T. 134 N.-R. 69 W. UNORGANIZED
- T. 134 N.-R. 68 W. UNORGANIZED
- T. 134 N.-R. 67 W. JANKE
- T. 133 N.-R. 73 W. UNORGANIZED
- T. 133 N.-R. 72 W. UNORGANIZED
- T. 133 N.-R. 71 W. UNORGANIZED
- T. 133 N.-R. 70 W. UNORGANIZED
- T. 133 N.-R. 69 W. UNORGANIZED
- T. 133 N.-R. 68 W. UNORGANIZED
- T. 133 N.-R. 67 W. HAAS

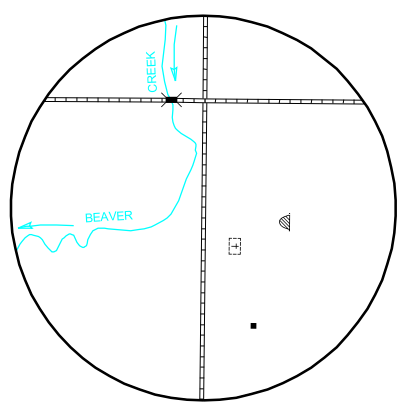

INSET NO. 1
SECS. 13, 14, 23 & 24, T. 133 N., R. 73 W.

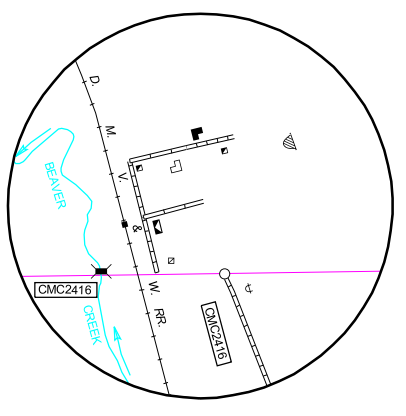

BURNSTAD
SECS. 29 & 32, T. 134 N., R. 71 W.



STATE OF NORTH DAKOTA
DIAGRAM OF COUNTIES

GENERAL HIGHWAY MAP
LOGAN COUNTY
NORTH DAKOTA

PREPARED BY THE
NORTH DAKOTA DEPARTMENT OF TRANSPORTATION
PLANNING AND PROGRAMMING DIVISION

IN COOPERATION WITH THE
U.S. DEPARTMENT OF TRANSPORTATION
FEDERAL HIGHWAY ADMINISTRATION

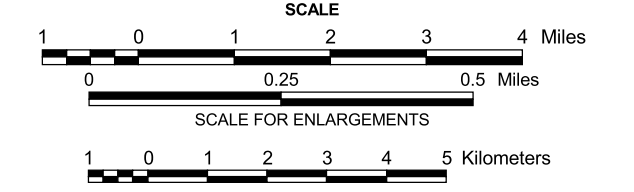

2002

BASED ON AERIAL PHOTOGRAPHY OF 1952
GROUND INVENTORY OF 2002
AERIAL INVENTORY OF 2002

UNIVERSAL TRANSVERSE MERCATOR ZONE 14
NORTH AMERICAN DATUM 83
(50,000 FOOT INTERVAL)