

# 2000 COUNTY FIRE DISTRICT MAP

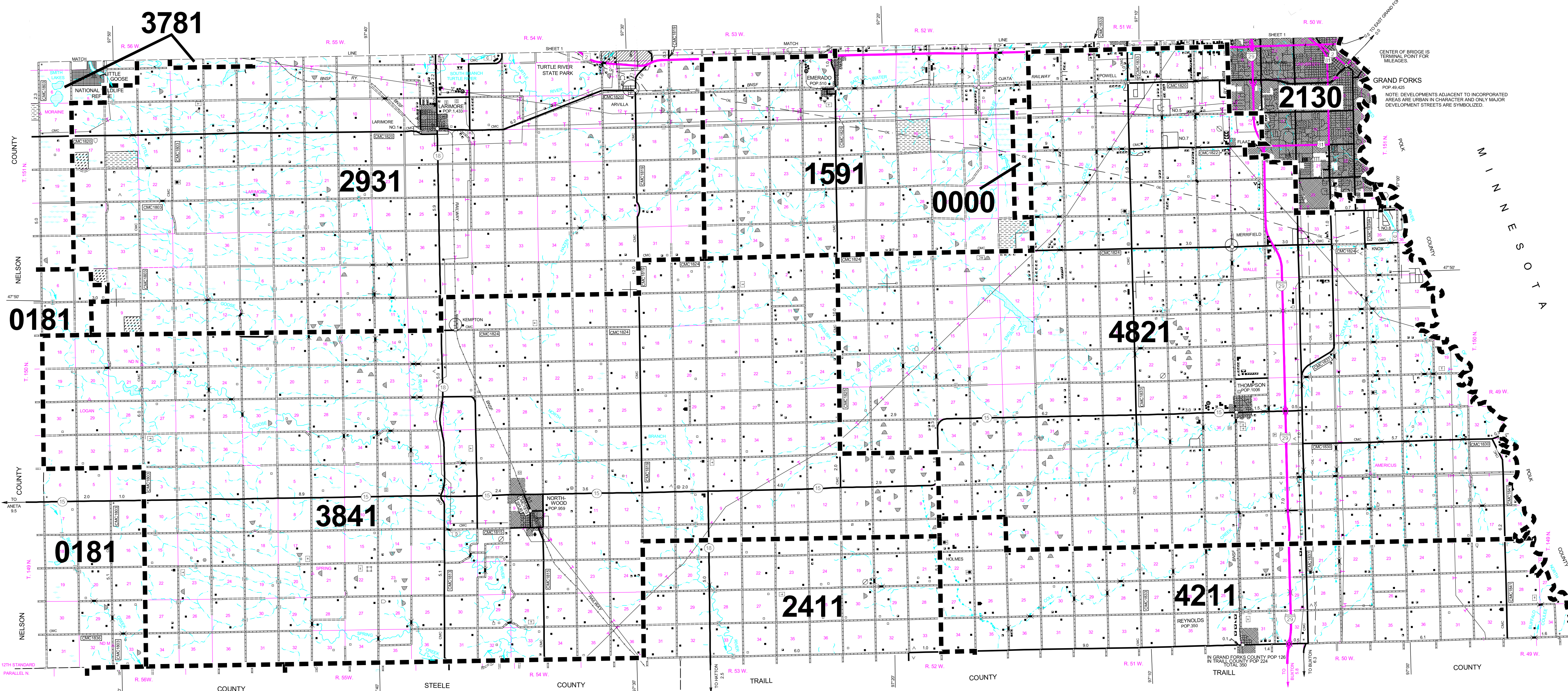

NAME AND LOCATION OF ORGANIZED CIVIL TOWNSHIPS THOSE UNORGANIZED ARE SO NOTED

- T. 154 N.-R. 56 W. ELM MOUNT
- T. 154 N.-R. 55 W. INKSTER
- T. 154 N.-R. 54 W. STRABANE
- T. 154 N.-R. 53 W. JOHNSTOWN
- T. 154 N.-R. 52 W. LEVANT
- T. 154 N.-R. 51 W. TURTLE RIVER
- T. 154 N.-R. 50 W. TURTLE RIVER
- T. 153 N.-R. 56 W. PLYMOUTH
- T. 153 N.-R. 55 W. AGNES
- T. 153 N.-R. 54 W. WHEATFIELD
- T. 153 N.-R. 53 W. GILBY
- T. 153 N.-R. 52 W. LAKEVILLE
- T. 153 N.-R. 51 W. FERRY
- T. 153 N.-R. 50 W. FERRY
- T. 152 N.-R. 56 W. NIAGARA
- T. 152 N.-R. 55 W. ELM GROVE
- T. 152 N.-R. 54 W. HEGTON
- T. 152 N.-R. 53 W. MEKINOCK
- T. 152 N.-R. 52 W. BLOOMING
- T. 152 N.-R. 51 W. RYE
- T. 152 N.-R. 50 W. FALCONER
- T. 151 N.-R. 56 W. MORaine
- T. 151 N.-R. 55 W. LARIMORE
- T. 151 N.-R. 54 W. ARVILLA
- T. 151 N.-R. 53 W. CHESTER
- T. 151 N.-R. 52 W. OAKVILLE
- T. 151 N.-R. 51 W. BRENA
- T. 151 N.-R. 50 W. GRAND FORKS
- T. 150 N.-R. 56 W. LOGAN CENTER
- T. 150 N.-R. 55 W. GRACE
- T. 150 N.-R. 54 W. AVON
- T. 150 N.-R. 53 W. PLEASANT VIEW
- T. 150 N.-R. 52 W. FAIRFIELD
- T. 150 N.-R. 51 W. ALLENDALE
- T. 150 N.-R. 50 W. WALLE
- T. 149 N.-R. 56 W. WALLE
- T. 149 N.-R. 55 W. LORETTA
- T. 149 N.-R. 54 W. LIND
- T. 149 N.-R. 53 W. WASHINGTON
- T. 149 N.-R. 52 W. LINCOLN
- T. 149 N.-R. 51 W. MICHIGAN
- T. 149 N.-R. 50 W. AMERICUS
- T. 149 N.-R. 49 W. BENTRU

- 0000 - UNCLAIMED
- 0181 - ANETA F/P DISTRICT
- 1591 - EMERADO FURAL FIRE DEPT
- 2411 - HATTON RURAL FIRE DEPT
- 2931 - LARIMORE RURAL FIRE DEPT
- 3781 - NIAGARA F/P DISTRICT
- 3841 - NORTHWOOD F/P DISTRICT
- 4211 - REYONOLDS F/P DISTRICT
- 4821 - THOMPSON F/P DISTRICT

- CITY FIRE DEPARTMENTS
- 1590 - EMERADO FIRE DEPT
  - 2130 - GRAND FORKS FIRE DEPT
  - 2930 - LARIMORE FIRE DEPT

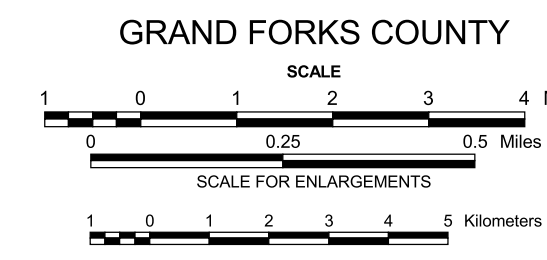
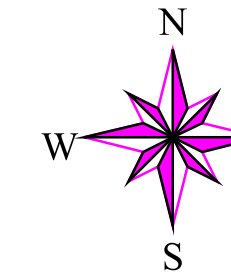

2006

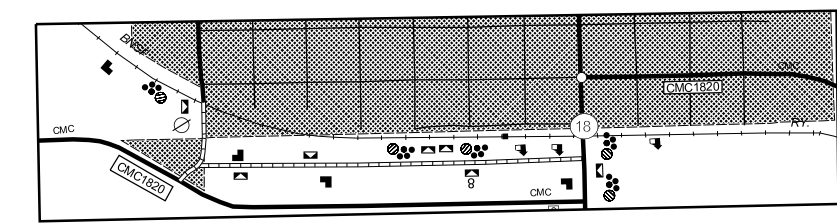

LARIMORE NO. 1  
SECS 1 & 12, T. 151 N., R. 55 W.  
SECS 6 & 7, T. 151 N., R. 54 W.

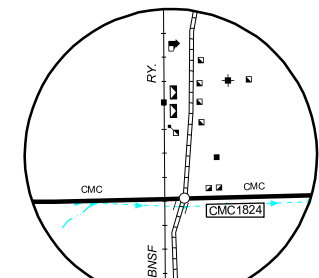

MERRIFIELD  
SEC 31, T. 151 N., R. 50 W.  
SEC 36, T. 151 N., R. 51 W.  
SEC 6, T. 150 N., R. 50 W.  
SEC 1, T. 150 N., R. 50 W.

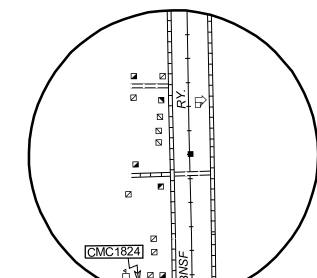

KEMPTON  
SECS 7, & 18, T. 150 N., R. 54 W.

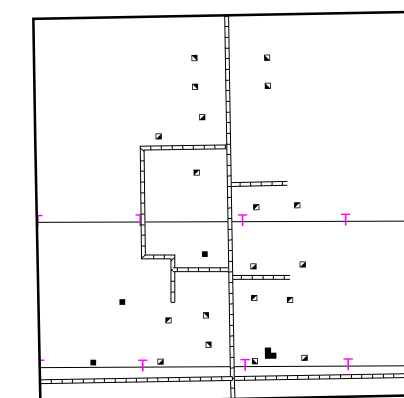

INSET NO. 5  
SECS 10, 11, 14, & 15, T. 151 N., R. 51 W.

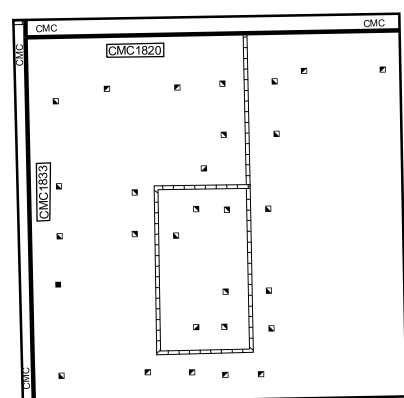

INSET NO. 6  
SECS 3, 4, 9, & 10, T. 151 N., R. 51 W.

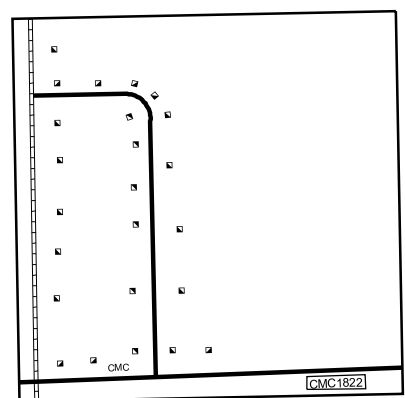

INSET NO. 7  
SECS 14, 15, 22 & 23, T. 151 N., R. 51 W.

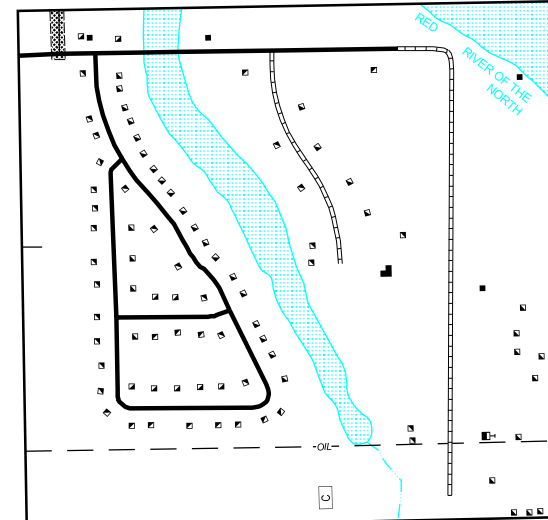

INSET NO. 8  
SECS 25, 26, 35, & 36, T. 151 N., R. 50 W.

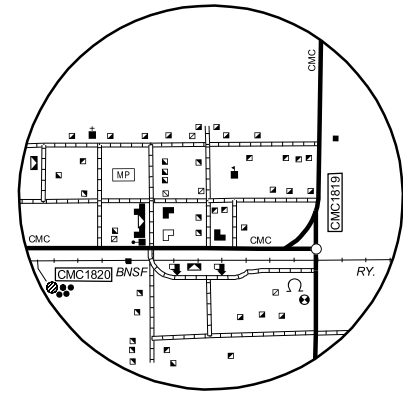

ARVILLA  
SECS 6, & 7, T. 151 N., R. 53 W.  
SECS 1, & 12, T. 151 N., R. 54 W.

COPIES OF THIS MAP ARE AVAILABLE FOR PUBLIC USE AT A NOMINAL COST FROM:  
MAP SALES, N.D. DEPARTMENT OF TRANSPORTATION, 608 E. BLVD. AVE., BISMARCK, N.D. 58505-0700